

WELD FLANGES – STAINLESS STEEL NN, CARBON STEEL ON

For mechanical fixing of sensors with thread.

For type: **DLS-27; CLS-23**

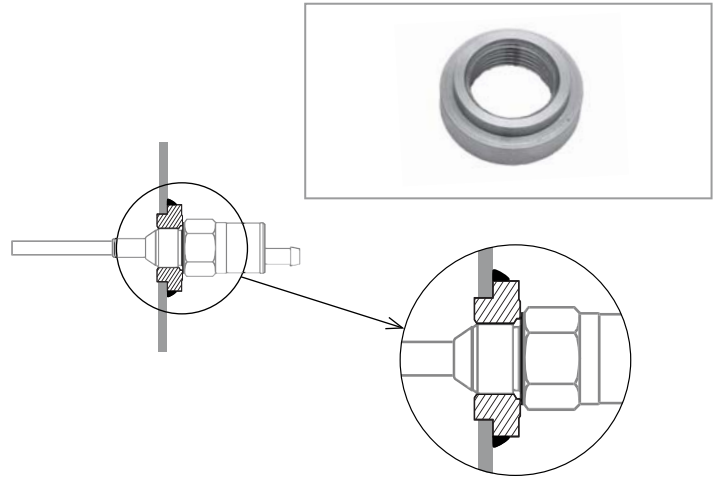
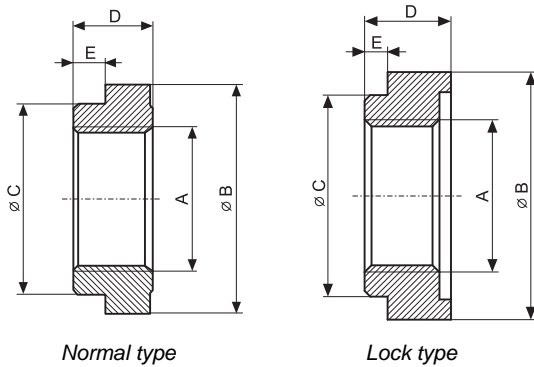

Type	For sensors	A	B (mm)	C (mm)	D (mm)	E (mm)	Material	Note
ON-18x1,5	CLS-23; (CLS-18)	M18x1.5	29.5	25	13	4	W. Nr. 1.0038 (AISI 1020)	
NN-18x1,5	CLS-23; (CLS-18)	M18x1.5	29.5	25	13	4	W. Nr. 1.4301 (AISI 304)	
ON-20x1,5	CLS-23	M20x1.5	29.5	25	13	4	W. Nr. 1.0038 (AISI 1020)	
NN-20x1,5	CLS-23	M20x1.5	29.5	25	13	4	W. Nr. 1.4301 (AISI 304)	
ON-27x2	DLS-27	M27x2	43	35	15	5	W. Nr. 1.0038 (AISI 1020)	
NN-27x2	DLS-27	M27x2	43	35	15	5	W. Nr. 1.4301 (AISI 304)	
ON-G3/8	CLS-23	G3/8"	29.5	25	13	4	W. Nr. 1.0038 (AISI 1020)	
ON-G3/8-Z	CLS-23	G3/8"	29.5	25	13	4	W. Nr. 1.0038 (AISI 1020)	With lock *
NN-G3/8	CLS-23	G3/8"	29.5	25	13	4	W. Nr. 1.4301 (AISI 304)	
NN-G3/8-A	CLS-23	G3/8"	29.5	25	13	4	W. Nr. 1.4571 (AISI 316 Ti)	
NN-G3/8-Z	CLS-23	G3/8"	29.5	25	13	4	W. Nr. 1.4301 (AISI 304)	With lock *
ON-G1/2	CLS-23	G1/2"	29.5	25	13	4	W. Nr. 1.0038 (AISI 1020)	
NN-G1/2	CLS-23	G1/2"	29.5	25	13	4	W. Nr. 1.4301 (AISI 304)	
ON-G3/4	DLS-27	G3/4"	43	35	15	5	W. Nr. 1.0038 (AISI 1020)	
ON-G3/4-Z	DLS-27	G3/4"	43	35	15	5	W. Nr. 1.0038 (AISI 1020)	With lock *
NN-G3/4	DLS-27	G3/4"	43	35	15	5	W. Nr. 1.4301 (AISI 304)	
NN-G3/4-A	DLS-27	G3/4"	43	35	15	5	W. Nr. 1.4571 (AISI 316 Ti)	
NN-G3/4-Z	DLS-27	G3/4"	43	35	15	5	W. Nr. 1.4301 (AISI 304)	With lock *

* Include Al seal, suitable for pressure applications

WELD FLANGES – STAINLESS STEEL NN, CARBON STEEL ON

For mechanical fixing of sensors with thread.

For type: **CLM-36; ULM-53; ULM-70; CLS-53**

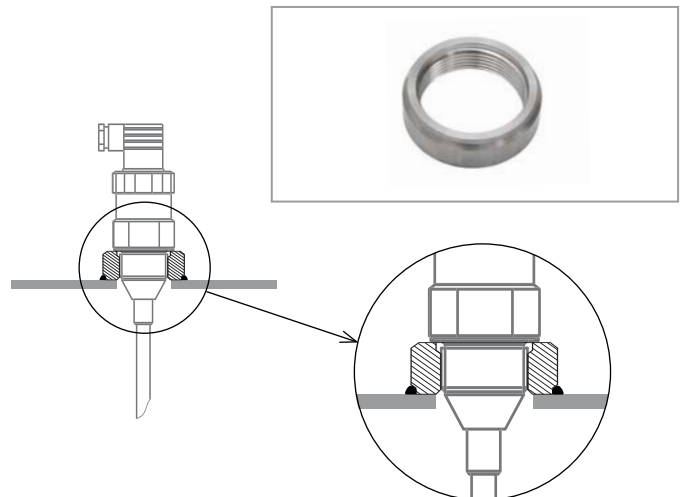
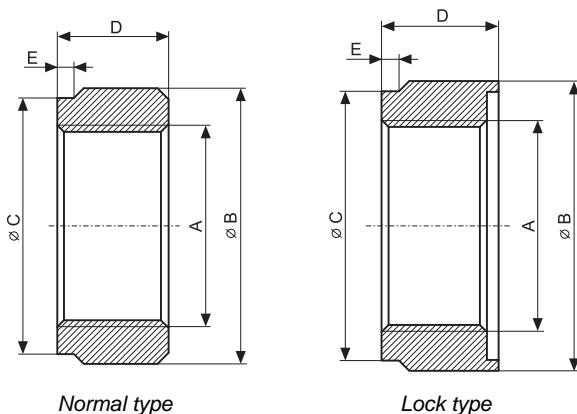

Type	For sensors	A	B (mm)	C (mm)	D (mm)	E (mm)	Material	Note
ON-36x2	CLM-36	M36x2	49.5	46	20	3	W. Nr. 1.0038 (AISI 1020)	
ON-36x2-Z	CLM-36	M36x2	49.5	46	20	3	W. Nr. 1.0038 (AISI 1020)	With lock*
NN-36x2	CLM-36	M36x2	49.5	46	20	3	W. Nr. 1.4301 (AISI 304)	
NN-36x2-Z	CLM-36	M36x2	49.5	46	20	3	W. Nr. 1.4301 (AISI 304)	With lock*
ON-G1	ULM-70/53-02; CLM-36	G1"	49.5	46	18	3	W. Nr. 1.0038 (AISI 1020)	
NN-G1	ULM-70/53-02; CLM-36	G1"	49.5	46	18	3	W. Nr. 1.4301 (AISI 304)	
NN-G1-A	CLM-36	G1"	49.5	46	18	3	W. Nr. 1.4571 (AISI 316 Ti)	
ON-G1,5	ULM-70/53-06; CLS-53	G1½"	59.5	56	18	3	W. Nr. 1.0038 (AISI 1020)	
NN-G1,5	ULM-70/53-06; CLS-53	G1½"	59.5	56	18	3	W. Nr. 1.4301 (AISI 304)	

* Include Al seal, suitable for pressure applications,

FIXING NUTS – STAINLESS STEEL UM, PLASTIC PUM

For mechanical fixing sensors in the cases when the use of weld flanges is not possible.

Material: UM – W. Nr. 1.4301 (AISI 304)
PUM – PP (Polypropylene) + GF30 (Glass fiber)

For type: CLM; ULM; CLS; DLS



Type	For sensors	A	B (mm)	C (mm)	D (mm)
UM-18x1,5	CLS-23; (CLS-18)	M18x1.5	23	8	24
UM-27x2	DLS-27	M27x2	34	10	36
UM-36x2	CLM-36	M36x2	44	14	46
UM-G3/8	CLS-23	G3/8"	23	8	24
UM-G3/4	DLS-27	G3/4"	34	10	36
UM-G1	ULM-53/70-02; CLM-36	G1"	45.4	12	46
UM-G1,5	ULM-53/70-06; CLM-36-40, CLS-53	G1½"	54	14	55
PUM-G1	ULM-53/70-02, CLM-36	G1"	45.4	12	46
PUM-G1,5	ULM-53/70-06; CLM-36-40, CLS-53	G1½"	54.8	14	55

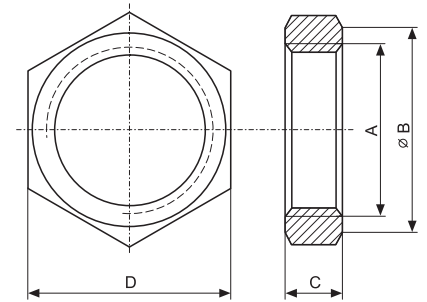

SOCKET GAN-DADE 7A AND GAN-DAEE 7A

Cable socket with molded lead and central screw M3, cable length 5 m.

For type: ULM-53; CLM-36; CLS-53



TECHNICAL DATA	
Rated voltage	250 V AC/DC
Rated current	10 A
Protection class	IP67
Contact resistance	Max. 10 mΩ
Cable specification	GAN-DADE 7A GAN-DAEE 7A
	LiYY 3x0.75 mm ² LiYY 4x0.75 mm ²
Cable material	PVC (Polyvinyl chloride)
Contact material	Cu / Sn
Temperature range	-25 ... +80°C

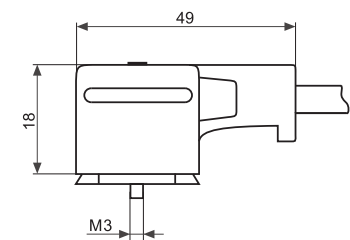

Legend:

BN – Brown
BK – Black
BU – Blue
GNYE – Green/Yellow

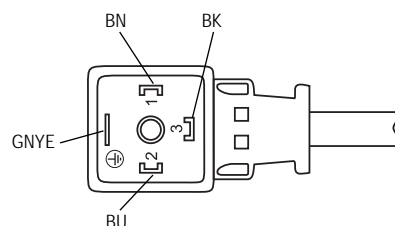

GAN-DAEE 7A (3+PE)

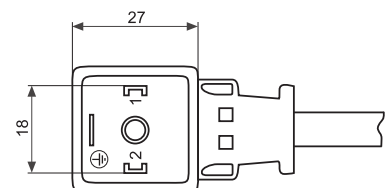

GAN-DADE 7A (2+PE)

SOCKET ELWIKA KV 4312

Angled cable socket with integrally molded lead and self securing lock nut, high flexible cable (2 m or 5 m).

For type: **DLS-27; CLS-23; CPS-24**

TECHNICAL DATA	
Rated voltage	250 V AC/DC
Rated current	4 A
Protection class	IP68
Cable specification	LiYY 3x0.34 mm ²
Cable material	PVC (Polyvinyl chloride)
Contact material	Cu Zn / Au
Screw locking nut	M12
Temperature range	-25 ... +90°C

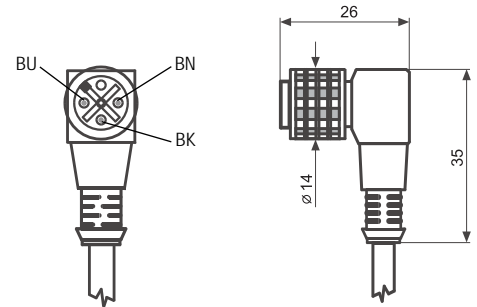

SOCKET ELKA KV 3308

Straight cable socket with integrally molded lead, self-securing lock nut, high flexible cable (2 m).

For type: **GPLS-25**

TECHNICAL DATA	
Rated voltage	60 V AC/DC
Rated current	3 A
Protection class	IP68
Cable specification	LiYY 3x0.25 mm ²
Cable material	PVC (Polyvinyl chloride)
Screw locking nut	M8
Contact material	Cu Sn / Au
Temperature range	-25 ... +90°C

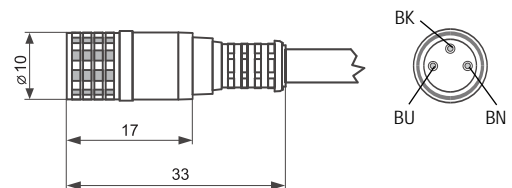

Legend:

BN – Brown
BK – Black
BU – Blue

SOCKET ELKA 4012 AND ELWIKA 4012

Straight and angle cable socket, disassembled, internal screw terminals, plastic coupling nut.

For type: **DLS-27; CLS-23; CPS-24**

TECHNICAL DATA	
Rated voltage	250 V AC/DC
Rated current	4 A
Protection class	IP67
Suitable cables	Diameter 4 – 6 mm, Max 0.75 mm ²
Coupling nut	M12
Contact material	Cu Zn / Sn
Temperature range	-25 ... +90°C

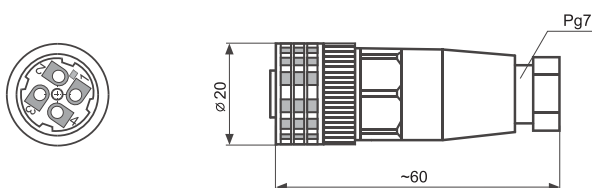

Inside of the connector

ELKA 4012

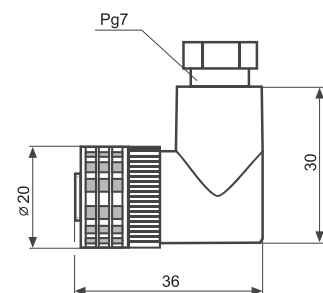

ELWIKA 4012

CABLE SOCKET CA 3 LD AND PLUG CA 3 LS, PANEL SOCKET CA 3 GD

Straight cable socket and plug with internal screw terminals.

TECHNICAL DATA	
Rated voltage	400 V AC / 250 V DC
Rated current	AC 16 A / DC 10 A
Protection class	IP67
Contact resistance	3 mΩ
Conductor size	Max. 2.5 mm ²
Cable gland	M22
Contact material	Ag
Temperature range	-40 ... +90°C

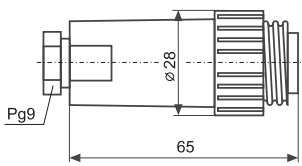
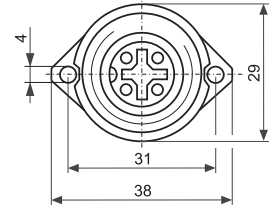

CA 3 LS

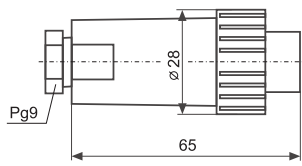
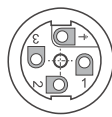

CA 3 LD

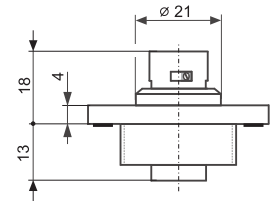
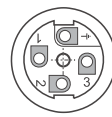

CA 3 GD

RELAYS RY 2100XX, DIN RELAY SOCKET RY 78626

For safety switching of higher loads by means of sensors with non-contact output. Available with relay socket RY 78626 for DIN rail mounting 35 mm.

For type: DLS-27; CLS-23; CPS-24; GPLS-25; FLD-48

TECHNICAL DATA – RELAY		
Coil voltage	RY210024	24 V DC
	RY210012	12 V DC
Coil current	RY210024	10 mA
	RY210012	19 mA
Contact material		AgCdO
Rated current		8 A (250 V AC)
Maximum breaking capacity AC		2000 VA
Rated frequency of operation with load		Max. 360/hour
Mechanical endurance		3 x 10 ⁶ cycles
Dielectric strength coil-contact circuit		5 kV
Temperature range		-40 ... +70°C

TECHNICAL DATA – RELAY SOCKET	
Dielectric strength coil-contact circuit	4 kV
Protection class	IP20
Temperature range	-20 ... +80°C

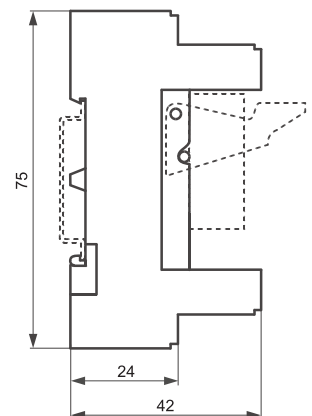
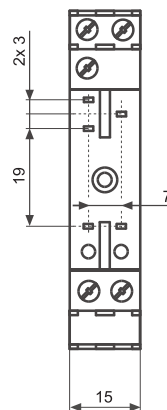
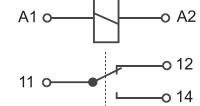
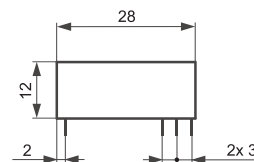

HORN ADAPTER ST

For increases the radiation directivity of acoustic waves, improves reception of weak echoes (unstable level surfaces, solid materials, etc.), and reduces the risk of false reflections.

For type: **ULM-53; ULM-70**

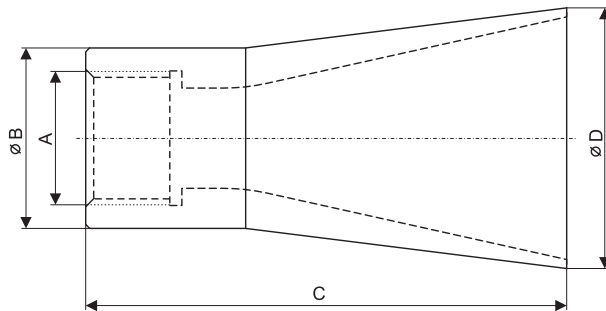

Type	For level meters	A	B (mm)	C (mm)	D (mm)	Material
ST-G1	ULM-53-02; ULM-70-02	G1"	45	120	65	PP (Polypropylene)
ST-G1,5	ULM-53-06; ULM-70-06	G1½"	56	160	100	PP (Polypropylene)

PLATE HOLDER PD-24-1

For fixing of the sensors CPS-24 (Include fixative strips).

Material: W. Nr. 1.0036 Nickel plated

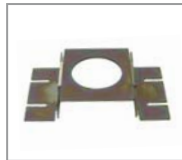
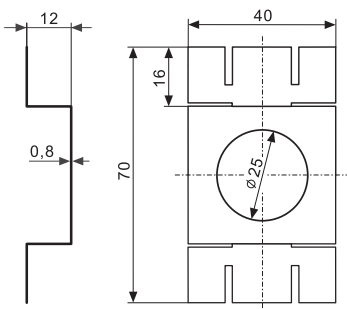

DISTANCE CROWN DK-24

For protection of sensor CPS-24 self-activation.

Material: POM-C (Polyoxymethylene copolymer)

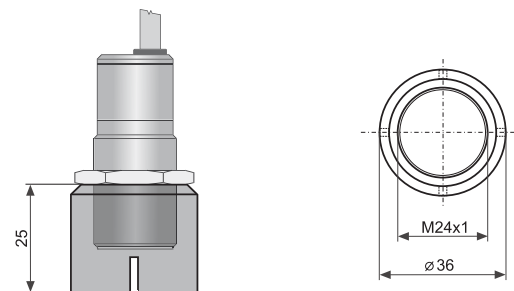

CABLE HANGER KD-60

For hydrostatic level meters HLM safety cable hanging.

Material: plastic

For type: **HLM-25S; HLM-25N; HLM-16N**

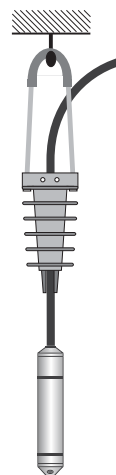
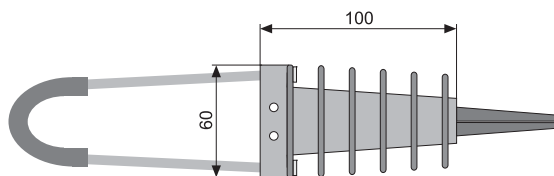

AUXILIARY PLATE ELECTRODE PDE

The set of auxiliary plate electrode, plate bracket with weld flange and connecting steel cable allows installation of capacitive level sensors in plastic (electric non-conductive) tanks in a vertical position. At the top wall is by 4 screws mounted plate bracket with stainless steel welding flange and the capacitive sensor (with rod electrode) is screwed into it. Plate electrode (thickness 1 mm) is fixed on outer side of the tank by means of double self adhesive layer in a position of considered sensing point. Stainless steel cable connects the plate bracket with the plate electrode. For details see the instruction manuals of the appropriate sensors.



For type: **DLS-27; CLS-23**

Legend:

- 1 – Welding flange for sensor
- 2 – Plate bracket
- 3 – Connecting steel cable
- 4 – Mounting hole
- 5 – Plate electrode

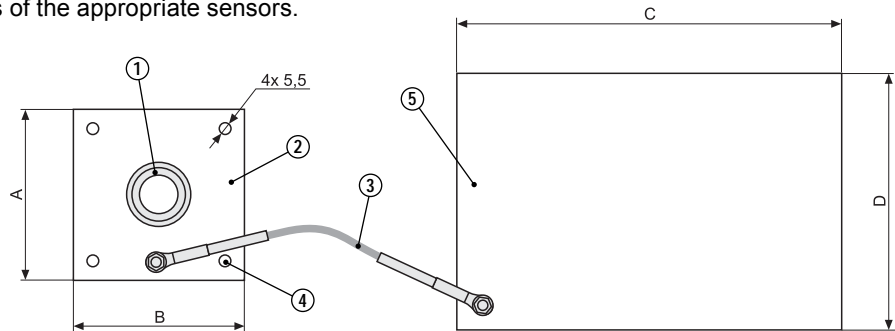

Type	For sensors	Weld flange	A (mm)	B (mm)	C (mm)	D (mm)	Material	Steel cable length (cm)
PDE-18	CLS-23; (CLS-18)	NN-18x1,5	80	80	180	120	W. Nr. 1.4301 (AISI 304)	50; 100; 150
PDE-27	DLS-27	NN-27x2	90	90	180	120	W. Nr. 1.4301 (AISI 304)	50; 100; 150

INFRARED REMOTE CONTROLLER RCW-1

For parameters setting PDU display units without opening front lid.

For type: **PDU-420-W**



TECHNICAL DATA

Power supply voltage	6 V DC (4 pc alkaline batteries LR44)
Operation range	Max. 5 m
Operating / Storage temperature	0 ... +50°C / -10 ... +70°C
Dimension (W x H x D)	38 x 65 x 15 mm

DISPLAY UNIT DM-70

For parameters setting and local display of measured values ultrasonic level meters. Matrix OLED display, 3 button membrane keypad.

For type: **ULM-70**



TECHNICAL DATA

Supply voltage	18 ... 36 V DC
Display type	Matrix OLED
Display resolution	128 x 64 pixel
Character height	9 mm (5 characters)
Display colour	Yellow
Button type	Low-lift, membrane
Temperature range	-30 ... +70 °C
Electrical connection	DIP 2x 5 pins
Weight	46 g

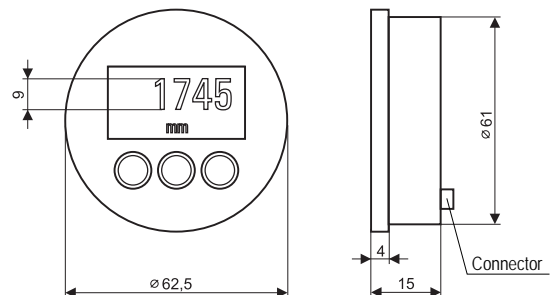

NON-HERMETIC (VENTED) JUNCTION BOX NB-01

For termination of hydrostatic level meter cable with compensation capillary and its electrical connection with the supply cable. Includes membrane for input of atmospheric pressure with protection against moisture. DIN rail mounted (35 mm), protection class IP65.

Material: PBT (Polybutylene terephthalate)

For type: HLM-25S; HLM-25N; HLM-16N



ADDITIONAL FRAME FOR PDU DISPLAY UNITS

Increases the protection class to IP65 of PDU units front panel.

Material: plastic

For type: PDU-420-P; PDU-421-P; PDU-440-P



MAGNETIC PEN MP-8

For parameters setting of limit level sensors.

For type: CLS-23; CLS-53; GPLS-25



DUST-TIGHT BUSHING PR-31

Dismountable Dust tight bushing PR-31 is the part for the CLM-36 level meter anchor mechanism. For fixing of the anchoring rod through the silo bottom wall. Dust-tight bushing must be welded into the conical silo bottom wall. Appropriate for powdery materials. For detailed information read the CLM-36 instruction manual.

Material: W. Nr. 1.4301 (AISI 304) – Inside
W. Nr. 1.0038 (AISI 1020) – Housing

For type: CLM-36_-31



ANCHOR WELDING CYLINDER KV-31

Anchor welding cylinder KV-31 is the part of the CLM-36 level meter anchor mechanism. For fixing of the anchoring rod through the silo bottom wall. Anchor welding cylinder must be welded into the conical silo bottom wall. Appropriate for use coarse grained, gritty bulky-solid materials (granulate etc.). For detailed information read the CLM-36 instruction manual.

Material: W. Nr. 1.0038 (AISI 1020)

For type: CLM-36_-31



INDUSTRIAL SEAL AND GASKETS

Asbestos free seal, thickness 2 mm, diameters (outer/inner): 24/18 mm, 27/20 mm, 36/27 mm, 43/33 mm, 46/36 mm and 55/47 mm. Aluminium seal, thickness 2 mm, diameters (outer/inner): 36/27 mm and 46/36 mm. Various Teflon® PTFE (Polytetrafluoroethylene) seal.

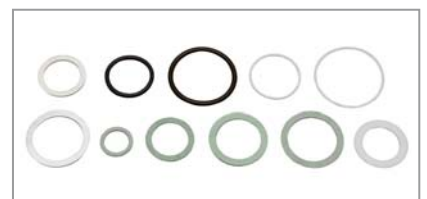

Version 10/2012